

RACING MODE

To select the Racing mode:

1. In the Sailing or Navigation mode, long press Enter to access the Set menu.
2. In the Set menu, scroll to Race and press Enter. The On/Off selection is activated.
3. Set the race function On with the arrow buttons and press Enter. The Racing mode is activated.

SETTING THE TIMER

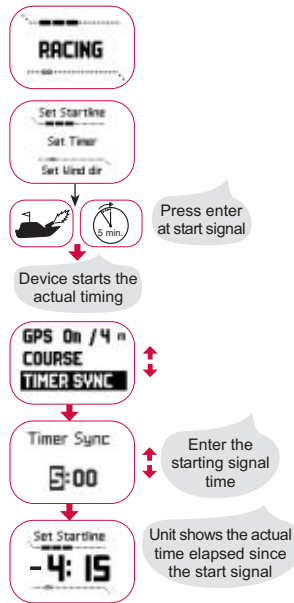

Timer can be resynchronized as many times as desired.

SETTING THE START LINE

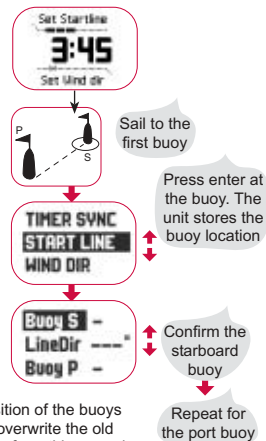

If you mark the position of the buoys again, the unit will overwrite the old position. You can perform this procedure as many times as required.

SETTING THE WIND DIR

Follows the same procedure as Setting the Start Line

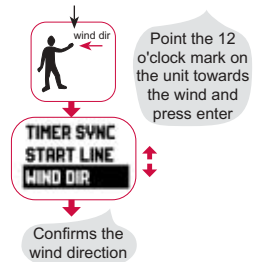

DURING THE RACE

Setting the tacking angle difference measurement (TAD):

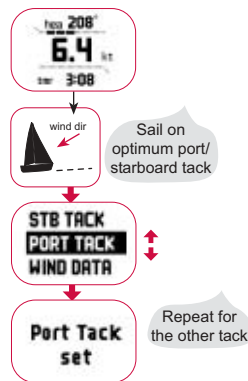

When there is a constant wind shift, repeat above procedure to reset the TAD.

HINTS AND TROUBLESHOOTING

Suunto M9 displays "GPS STOPPED" or "LOW BATTERY"
Suunto M9 shuts down the GPS automatically after 15 minutes if the unit does not get a fix and displays "GPS stopped". The GPS will also be shut down when the unit displays "Low Battery".

Why does not the Suunto M9 start guiding to the next waypoint after passing the previous waypoint?
The Navigate function must be set to On in the Navigation menu. When activating a route, the Navigation is set to Off as default. Select the desired Navigation mode (forward, reverse or single waypoint) to activate the guidance. This applies to race courses as well.

How can I make the battery last longer?

The main consumer of battery power is the GPS. You should use the GPS only when necessary. The memory storage (such as tracking) functions also consume power and should be avoided when battery power is low. Heavy use of the backlight consumes the battery fast.

What happens if the battery runs out during a race?

The GPS will shut down and you will lose location, distance, heading and speed information. All other functions that do not use the GPS (such as the race start timer and compass) work normally.

Why does the unit show different wind directions before race start and after start?

During the race start, Suunto M9 displays wind directions as line bias (the wind deviation from the perpendicular line to the start line) whereas during the race the unit displays the geographic wind directions.

Suunto M9 memory is full

The main reason is that there are too many tracks in the Suunto M9 memory. You can only erase the tracks by downloading them to the Suunto Sail Manager. You should always remove tracks from the unit while it is connected to the PC. You can also regulate the memory capacity by selecting a lower logging interval for the tracking function.

CONTACT INFORMATION

*SUUNTO CALL CENTER +358 2 284 1160
SUUNTO USA 1 (800) 543-9124
SUUNTO CANADA 1 (800) 776-7770

*Calls charged at standard call rate to Finland

SUUNTO M9 POCKET GUIDE

BUTTONS

START/DATA button

Short press:

- Starts the stopwatch or the compass
- Accesses the information displays in the Navigation, Sailing and Racing modes and the MOB function

Long press:

- Activates the backlight

- ↓ Long Enter
- ↕ Short Enter
- ↔ Arrows
- ✕ Stop/Cancel

UP and DOWN buttons:

- Switch between the main modes
- Scroll up and down in menus
- Increase/decrease the selected value

GPS signal strength

STOP/CANCEL button

Short press:

- Toggles shortcuts in the main modes
 - Returns to the previous menu/field
- Long press:
- Returns to the mode's main display
 - Resets the stopwatch

ENTER button

Short press:

- Enters the Function menu
 - Enters submenus
 - Accepts a selection
- Long press:
- Enters the Set menu
 - Accepts the selection and returns to the main menu

SUUNTO

HOW TO START NAVIGATING

1. Start the GPS
2. Select a route
3. Select Navigation mode
4. Navigation display guides you to the selected waypoint
5. Sailing display shows your current performance data

ACTIVATING A ROUTE FOR NAVIGATION

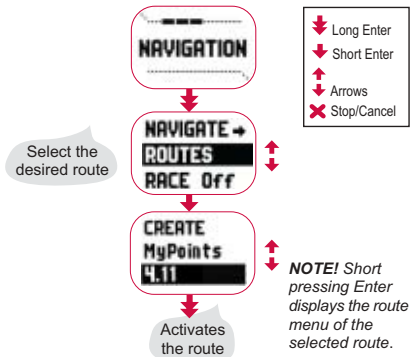

SELECTING A NAVIGATION MODE

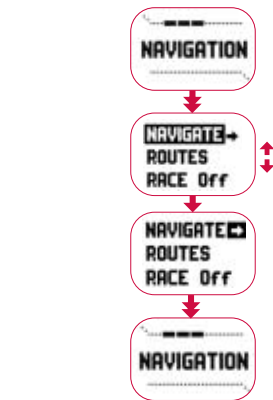

Choose one of the Navigation options

- Activates the route for navigating in the correct order, from beginning or active waypoint to the end
- ↵ Activates the route for navigating in the reversed order, from the end or from the active waypoint to the beginning
- Activates the navigation to a single chosen waypoint, on the selected route
- Navigation not active

CREATING A ROUTE/WAYPOINT

To create a new route/waypoint:

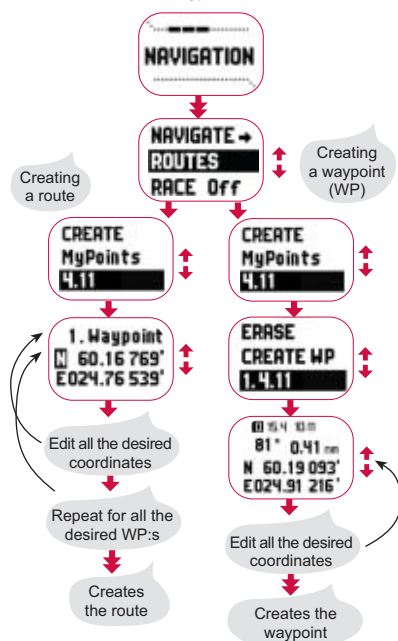

TRACKING

To set the Tracking function on or off:

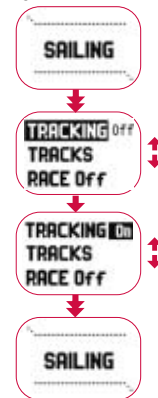

NOTE! The Tracking function stores the vessel's position heading and speed in the Suunto M9 memory when GPS is on. The save interval can be set in Suunto Sail manager.

MOB

Activating the MOB function:

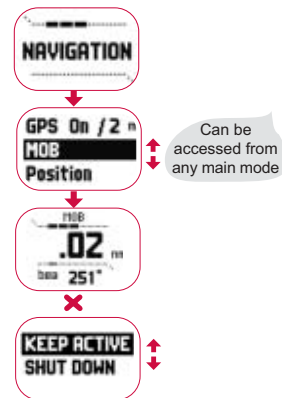

Press Start/Data to view the coordinates of the MOB location.

NOTE! If the GPS is not on when you navigate to the MOB menu, the GPS is automatically turned on and the text "MOB ACTIVATING" is displayed before entering the MOB menu.

NOTE! Shutting down the MOB function erases the location recorded earlier. "KEEP ACTIVE" allows you to return to the MOB display after using other modes.